

# FANTOM HARDWARE

---



**2** FANTOM-DS

**3** FANTOM-F



# FANTOM HARDWARE

## FANTOM-DS

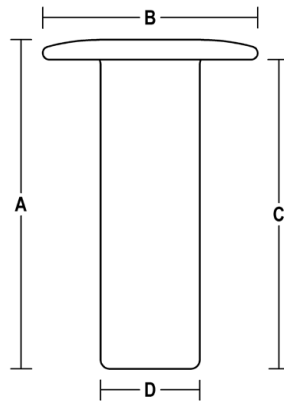

### FANTOM-DS FANTOM DOOR STOP

| NO.       | A               | B           | C          | D              | E                                 |
|-----------|-----------------|-------------|------------|----------------|-----------------------------------|
| FANTOM-DS | 1.8125" (45.75) | 1.125" (28) | 1.75" (43) | 0.5625" (13.8) | Strike: 1.3125" (33) x 3.15" (80) |

**FEATURED FINISHES:** Satin, Black, Clear

**FINISHES:** Satin, Chrome, Brass, Black, White, Clear

**NOTES:** Trip-Hazard Free, Fully Concealed, Hold-Open Feature, Magnetic Doorstop



# FANTOM HARDWARE

## FANTOM-F

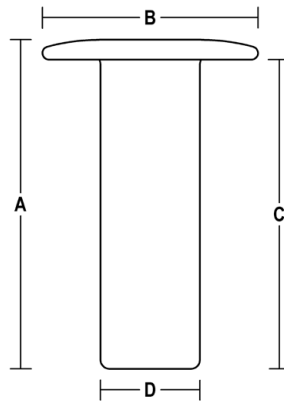

### FANTOM-F FANTOM FIRE DOOR STOP

| NO.      | A               | B           | C          | D              | E                               |
|----------|-----------------|-------------|------------|----------------|---------------------------------|
| FANTOM-F | 1.8125" (45.75) | 1.125" (28) | 1.75" (43) | 0.5625" (13.8) | Strike: 1.93" (49) x 2.36" (60) |

**FEATURED FINISHES:** Satin, Chrome, Clear

**FINISHES:** Satin, Chrome, Clear

**NOTES:** Fire-Rated, Trip-Hazard Free, No Hold-Open, Magnetic Doorstop